



EMERALD COAST CONFERENCE CENTER



IT'S BETTER HERE.



OVERVIEW

Situated on beautiful Okaloosa Island, the brand new Emerald Coast Conference Center is adjacent to 24 miles of sugar-white beaches and emerald-green waters which have earned praise by Southern Living readers, winning the magazine's Favorite Beach in the South award for eight consecutive years. An ideal location to host your organization's upcoming convention or trade show, the Center is easily accessible from more than 19,000 hotel, motel and condominium units and in close proximity to over 1,000 holes of world-class golf, deep-sea fishing, shopping and activities for the entire family. The Okaloosa Regional Airport is only minutes away for attendees convenience.

FEATURES:

- 35,000 sq. ft of flexible, column-free meeting and exhibit space
- A 21,500 sq. ft. Grand Ballroom with a seating capacity of more than 2,000 attendees
- 12 meeting rooms ranging from 450 to 1,800 sq. ft.
- State-of-the-art audio visual equipment and technicians located on property
- Access to four loading docks and drive-in ramp with entry into ballrooms
- Pre-function areas up to 4,000 sq. ft.
- Sporting event capabilities including basketball, wrestling and martial arts
- Complimentary parking
- A 6,000 sq. ft., fully equipped kitchen
- An experienced staff committed to exceeding your expectations through excellent customer service within a spotlessly clean, safe and comfortable environment

BANQUET SERVICES:

Our on-site caterer is Aramark. With nearly 30 years of experience creating food memories at some of the country's largest convention and event facilities, Aramark understands how to make a meal extraordinary. Whether you're planning a black-tie gala, conference luncheon or down-home barbeque, Aramark will give guests a true taste of the area with menus that highlight local color and flavor, delivered with a level of service our clients have come to expect.

ARAMARK LOGO





Meeting Room Name	Sec	Total Sq. Ft.	Dimension Height	Ceiling Capacity	Cocktail Capacity	Theatre Capacity	Classroom Occupancy	Banquet Sq. Setup	Hollow Setup	U-Shape Setup	Conference
Emerald Grand Ballroom and Exhibit Hall	4	21,000	223' x 95'	24 ft.	2400	2,350	1,584	1330	0	0	0
Emerald Ballroom I & II	2	16,000	169' x 95'	24 ft.	1800	1,739	1,188	980	0	0	0
Emerald Ballroom I	1	10,800	118' x 92'	24 ft.	1200	1,175	792	630	0	0	0
Emerald Ballroom II, III & IV	3	10,000	105' x 95'	24 ft.	1100	1,056	684	560	0	0	0
Emerald Ballroom III & IV	2	5,100	54' x 95'	24 ft.	500	480	306	280	0	0	0
Emerald Ballroom II	1	4,800	51' x 95'	24 ft.	500	460	306	280	0	0	0
Emerald Ballroom III	1	2,500	54' x 47'	24 ft.	250	220	144	140	72	56	42
Emerald Ballroom IV	1	2,500	54' x 47'	24 ft.	250	210	144	140	72	56	42
Palm	2	1,575	63' x 25'	10 ft.	165	150	108	90	64	56	50
Palm I	1	775	31' x 25'	10 ft.	80	75	45	40	32	24	24
Palm II	1	775	31' x 25'	10 ft.	80	75	45	40	32	24	24
Sunset	2	1,170	45' x 26'	10 ft.	120	110	72	60	40	40	34
Sunset I	1	575	22' x 26'	10 ft.	60	55	33	20	24	20	18
Sunset II	1	575	22' x 26'	10 ft.	60	55	33	20	24	20	18
Island	2	900	35' x 26'	10 ft.	100	92	60	50	32	32	26
Island I	1	450	17' x 26'	10 ft.	45	40	24	20	16	20	18
Island II	1	450	17' x 26'	10 ft.	45	40	24	20	16	20	18
Sandcastle	1	425	17' x 25'	10 ft.	45	44	21	20	16	20	18
Dolphin	1	425	17' x 25'	10 ft.	40	39	21	20	16	20	18
Pre-Function Area East	1	2,544	240' x 10'	0 ft.	0	0	0	0	0	0	0
Pre-Function Area South	1	1,272	120' x 10'	0 ft.	0	0	0	0	0	0	0

FLOOR PLAN

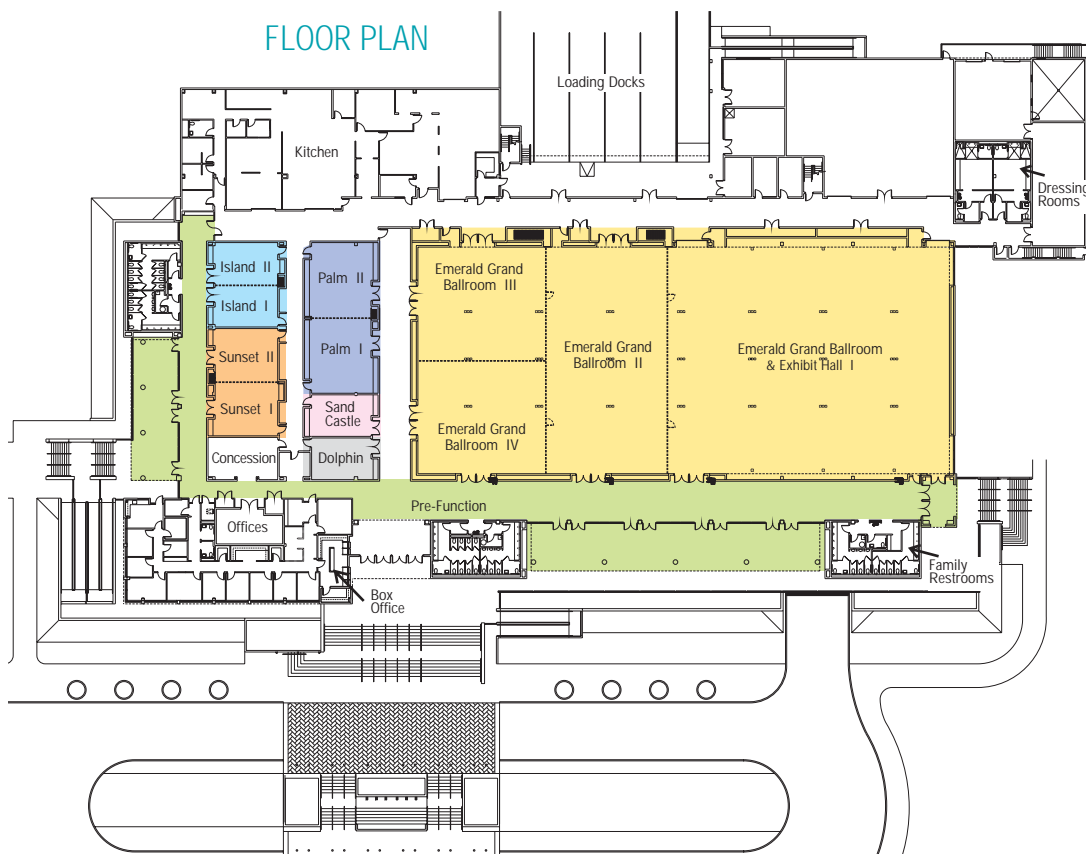

EMERALD COAST CONVENTION & VISITORS BUREAU, INC.

DESTIN FORT WALTON BEACH
OKALOOSA ISLAND CINCO BAYOU
MARY ESTHER

For more information please contact,

Emerald Coast Conference Center
1250 Miracle Strip Parkway SE
Fort Walton Beach, FL 32548
Phone: 850-609-3800
Fax: 850-609-5095
www.destin-fwb.com